

Road Map

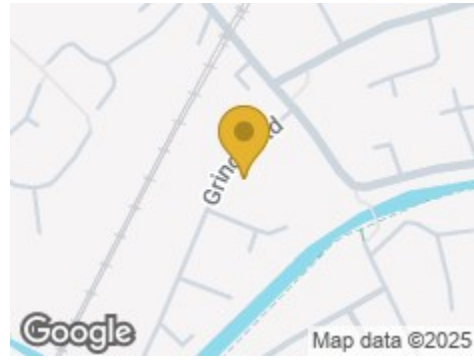

Hybrid Map



Terrain Map

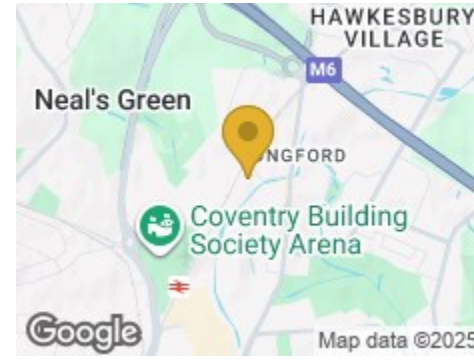

**MATTHEW JAMES**  
Property Services

Floor Plan

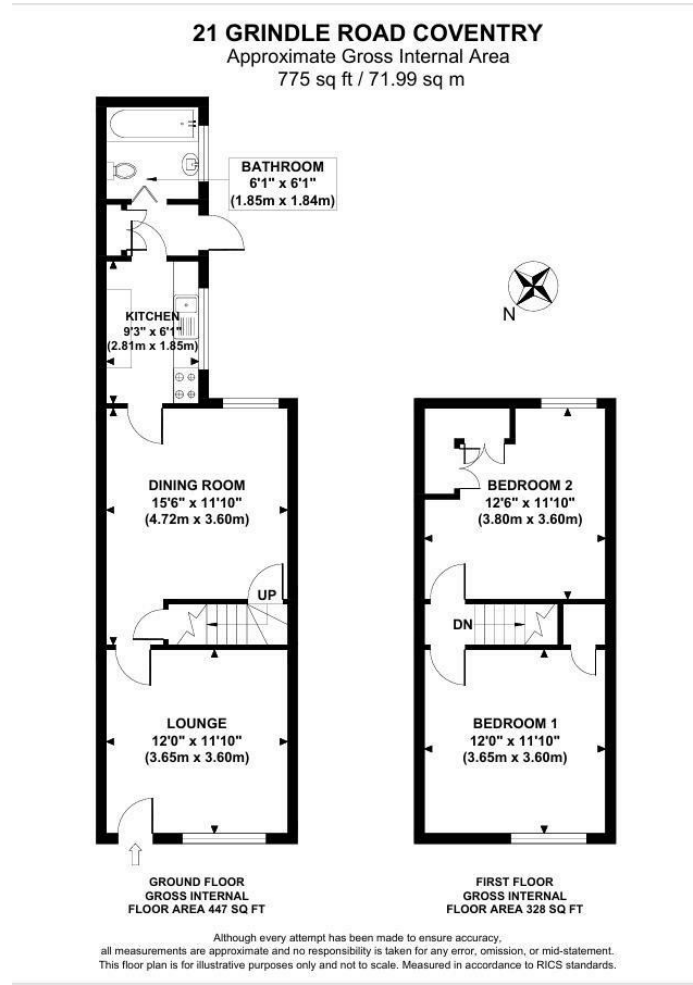

**21 Grindle Road**  
Longford, Coventry CV6 6BX

£150,000



Viewing

Please contact us on 02477 170170 if you wish to arrange a viewing appointment for this property or require further information.

Energy Efficiency Graph

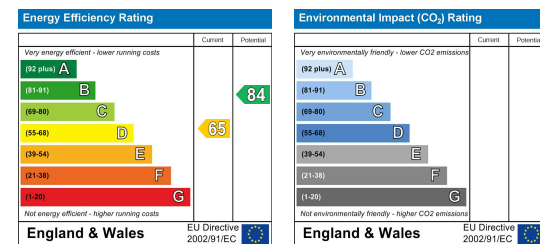

These particulars, whilst believed to be accurate are set out as a general outline only for guidance and do not constitute any part of an offer or contract. Intending purchasers should not rely on them as statements of representation of fact, but must satisfy themselves by inspection or otherwise as to their accuracy. No person in this firm's employment has the authority to make or give any representation or warranty in respect of the property.



CONTACT INFORMATION

24a Warwick Row, Coventry CV1 1EY

02477 170170

info@matthewjames.uk.com

www.matthewjames.uk.com

Facebook

Twitter

# 21 Grindle Road

Longford, Coventry CV6 6BX

£150,000



## Lounge

12'0 x 11'10

## Dining Room

15'6 x 11'10

## Kitchen

9'3 x 6'1

## Rear Lobby

## Bathroom

6'1 x 6'1

## Bedroom One

12'6 x 11'10

## Bedroom Two

12'0 x 11'0

## Rear Garden

